

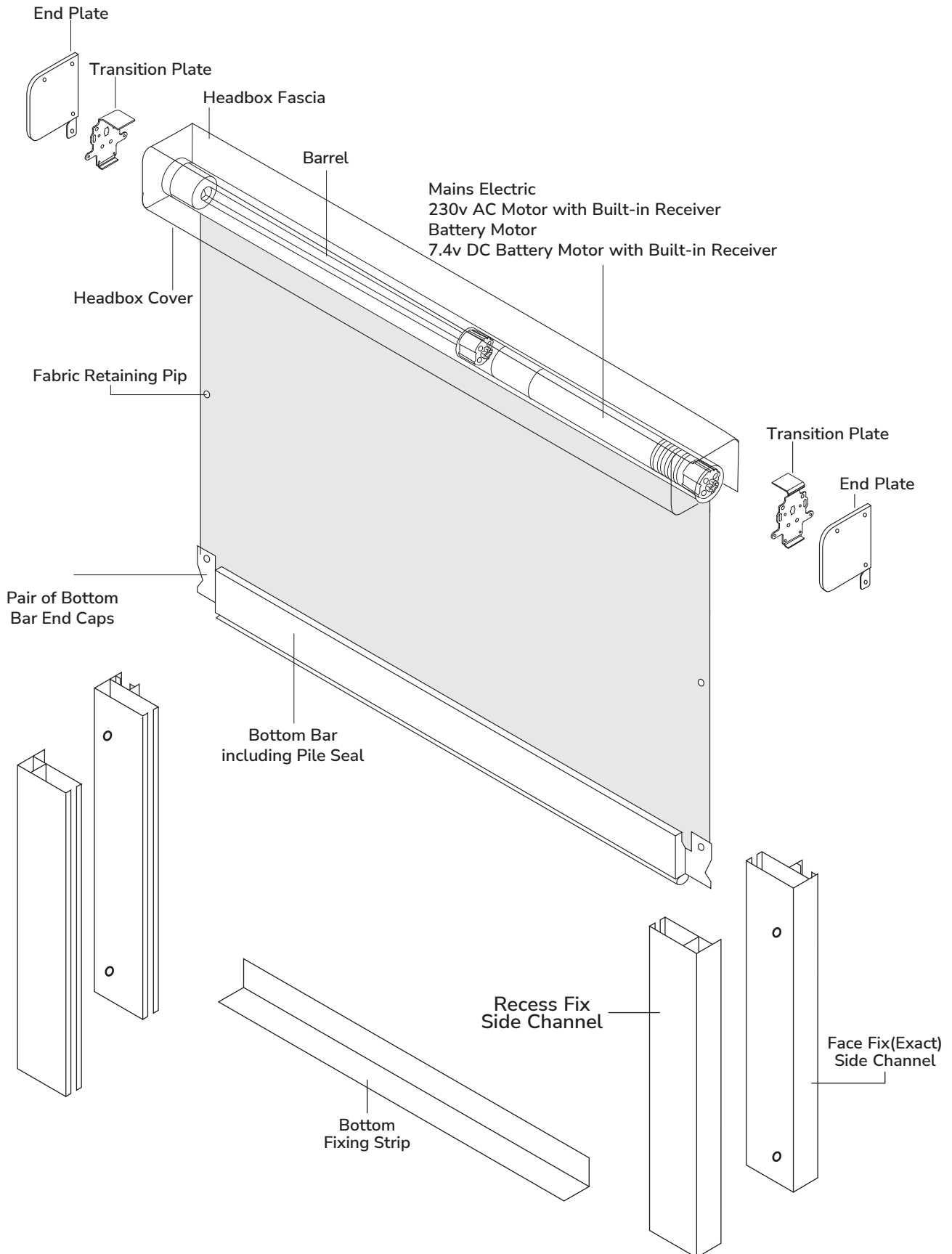

# DotcomBlinds | Blackout Cassette System

Mains & Battery Motor





# DotcomBlinds | Blackout Cassette System

Mains & Battery Motor

## Size Matrix

### Battery Standard Width

		Width											
Drop		600	800	1000	1200	1400	1600	1800	2000	2200	2400	2650	
	800	✓	✓	✓	✓	✓	✓	✓	✓	✓	✓	✓	✓
	1000	✓	✓	✓	✓	✓	✓	✓	✓	✓	✓	✓	✓
	1200	✓	✓	✓	✓	✓	✓	✓	✓	✓	✓	✓	✓
	1400	✓	✓	✓	✓	✓	✓	✓	✓	✓	✓	✓	✓
	1500	✓	✓	✓	✓	✓	✓	✓	✓	✓	✓	✓	✓

### Battery XL Wide Width

		Width											
Drop		600	800	1000	1200	1400	1600	1800	2000	2200	2400	2650	
	800	✓	✓	✓	✓	✓	✓	✓	✓	✓	✓	✓	✓
	1000	✓	✓	✓	✓	✓	✓	✓	✓	✓	✓	✓	✓
	1200	✓	✓	✓	✓	✓	✓	✓	✓	✓	✓	✓	✓
	1400	✓	✓	✓	✓	✓	✓	✓	✓	✓	✓	✓	✓
	1600	✓	✓	✓	✓	✓	✓	✓	✓	✓	✓	✓	✓
	1800	✓	✓	✓	✓	✓	✓	✓	✓	✓	✓	✓	✓
	2000	✓	✓	✓	✓	✓	✓	✓	✓	✓	✓	✓	✓

### Mains XL Wide Width

		Width															
Drop		600	800	1000	1200	1400	1600	1800	2000	2200	2400	2600	2800	3000	3200	3450	
	800	✓	✓	✓	✓	✓	✓	✓	✓	✓	✓	✓	✓	✓	✓	✓	✓
	1000	✓	✓	✓	✓	✓	✓	✓	✓	✓	✓	✓	✓	✓	✓	✓	✓
	1200	✓	✓	✓	✓	✓	✓	✓	✓	✓	✓	✓	✓	✓	✓	✓	✓
	1400	✓	✓	✓	✓	✓	✓	✓	✓	✓	✓	✓	✓	✓	✓	✓	✓
	1600	✓	✓	✓	✓	✓	✓	✓	✓	✓	✓	✓	✓	✓	✓	✓	✓
	1800	✓	✓	✓	✓	✓	✓	✓	✓	✓	✓	✓	✓	✓	✓	✓	✓
	2000	✓	✓	✓	✓	✓	✓	✓	✓	✓	✓	✓	✓	✓	✓	✓	✓
	2200	✓	✓	✓	✓	✓	✓	✓	✓	✓	✓	✓	✓	✓	✓	✓	✓
2450	✓	✓	✓	✓	✓	✓	✓	✓	✓	✓	✓	✓	✓	✓	✓	✓	



## Standard Width Headbox

Headbox Closed

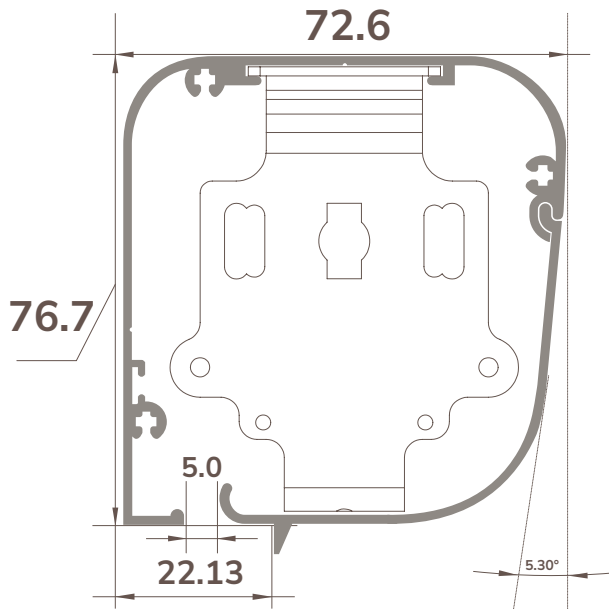

Headbox Open

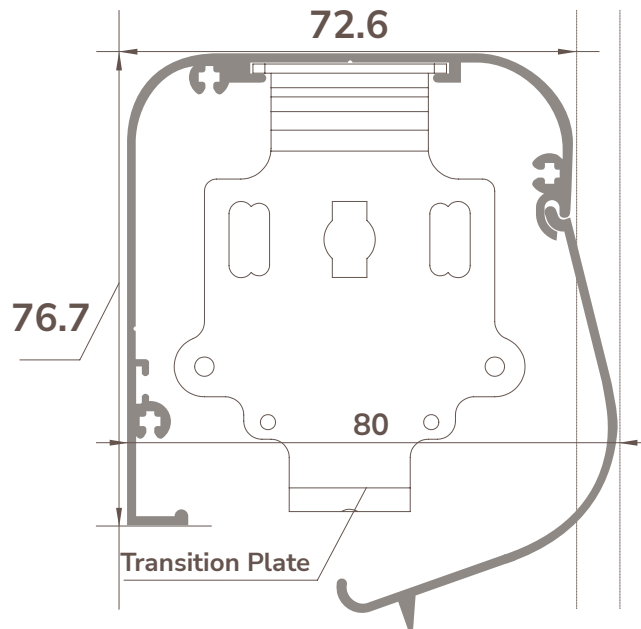

## XL Width Headbox

Headbox Closed

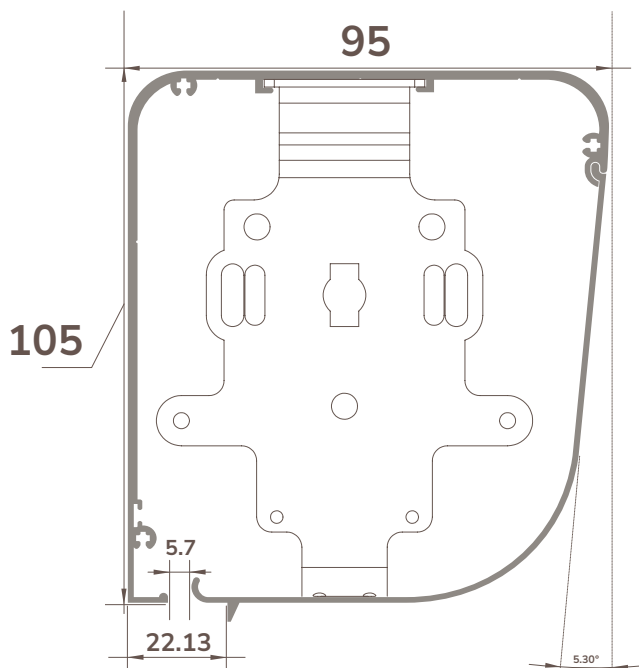

Headbox Open

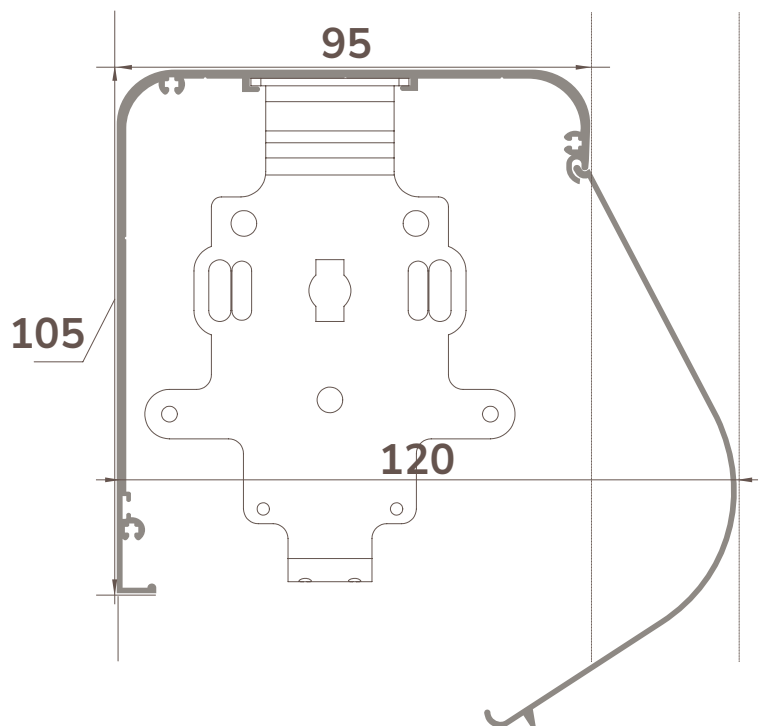



## XXL Width Headbox

Headbox Closed

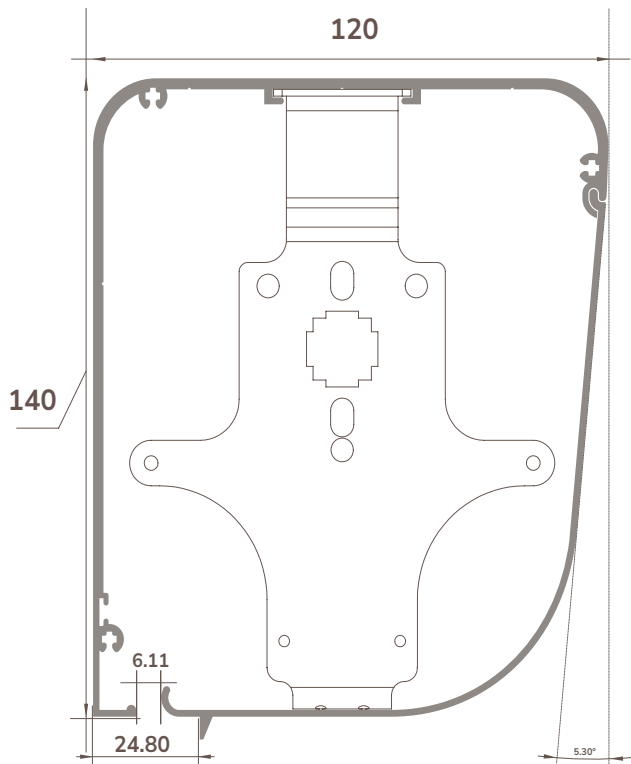

Headbox Open

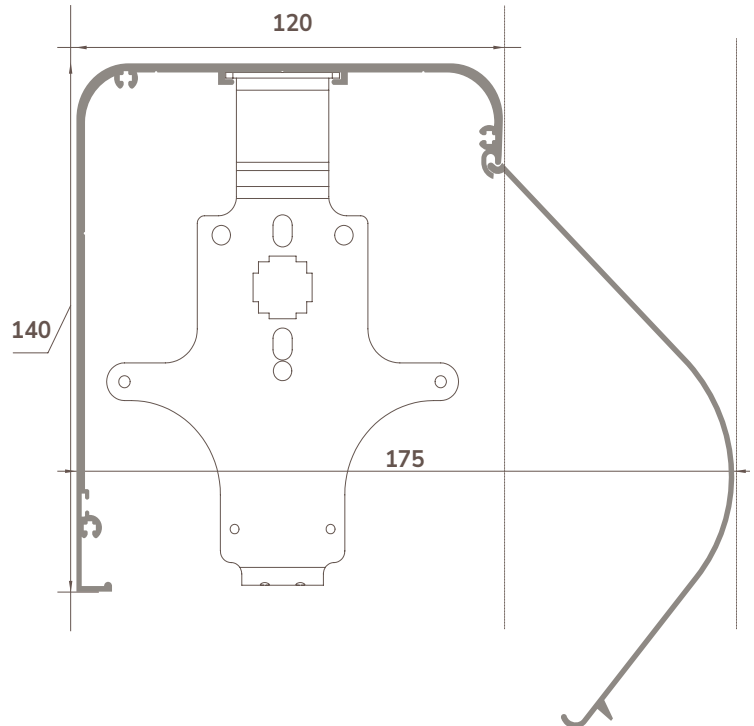



## Side Channel Profile

Recess

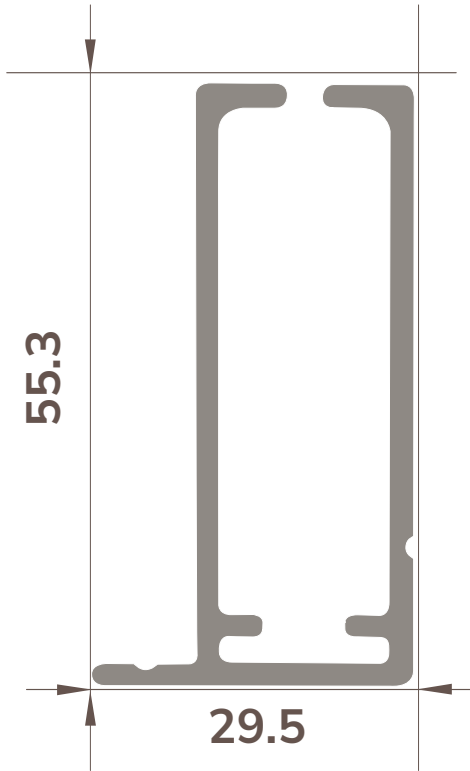

Face Fix

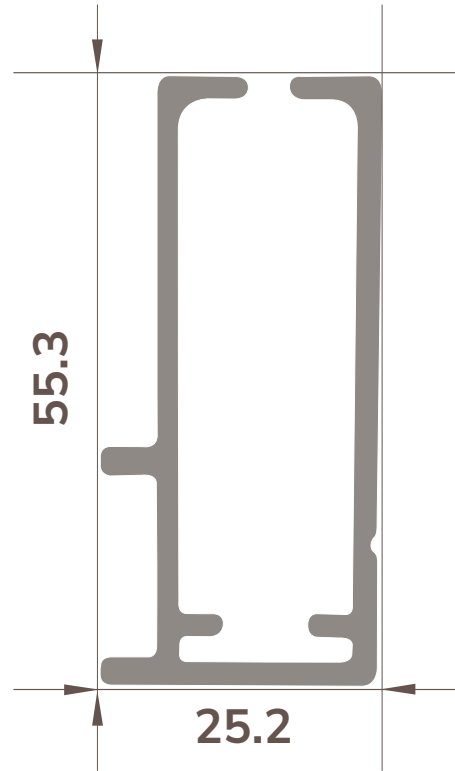

## Bottom Fixing Strip

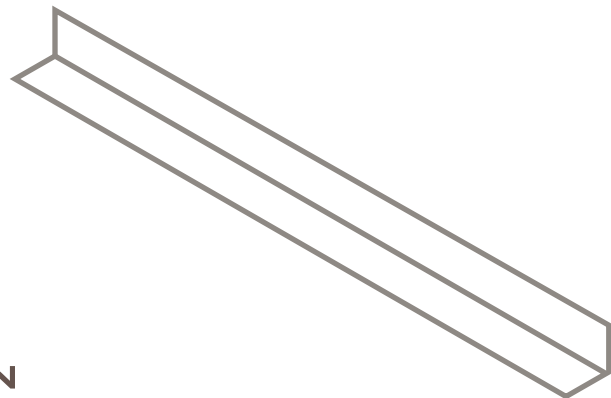
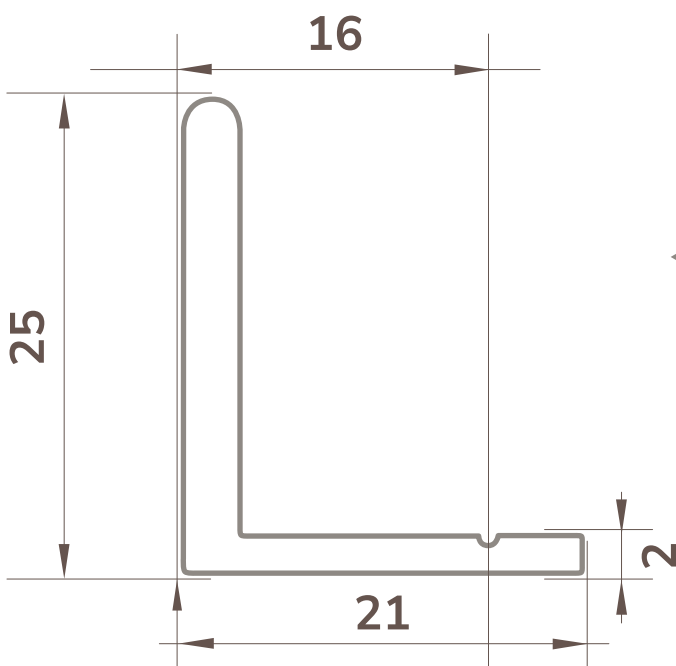



## Mains Electric Motor Technical Specification

Nominal Voltage	Power Tolerances	Thermal Time	No Wires in Cable	Wire Section	Insulation Class
230V - 50Hz	207-253V	4 mins	3	0.75	Class II

Type of Limit Switch	LSU Capacity	Limit Stop Accuracy	System of Protection	Drive Wheel Unclipping Force	Temp Working Range
Electronic	40 Turns	+ - 5°	IP44	Approx 10Kg	-5° C to +65°C

Noise Level	Nominal Torque	Nominal Speed	Rated Power	Rated Current	Weight
35dB	6.0N.m	28rpm(+/-5%)	115W	0.485A	1.4Kg

Noise Power Level (dB(A) ref 1pW): Power level (measurement between 20°C to 35°C): according to standards ISO 3741 NF31022 in dB (A) ref 1pW, worst value at nominal torque in up direction)

## Battery Motor Technical Specification

Nominal Voltage	Power Tolerances	Thermal Time	No Wires in Cable	Wire Section	Insulation Class
7.4V	7.4 -12V	4 mins	Cordless	N	Class II

Type of Limit Switch	LSU Capacity	Limit Stop Accuracy	System of Protection	Drive Wheel Unclipping Force	Temp Working Range
Electronic	200 Turns	+ - 2°	IP44	Approx 3Kg	-20° C to +65°C

Noise Level	Nominal Torque	Nominal Speed	Rated Power	Rated Current	Weight
40dB	1.0N.m	30rpm(+/-5%)	6.7W	0.560A	0.6Kg

Noise Power Level (dB(A) ref 1pW): Power level (measurement between 20°C to 35°C): according to standards ISO 3741 NF31022 in dB (A) ref 1pW, worst value at nominal torque in up direction)



## Solar Charing Panel

Suitable for DotcomBlinds Battery / Solar Blinds Only

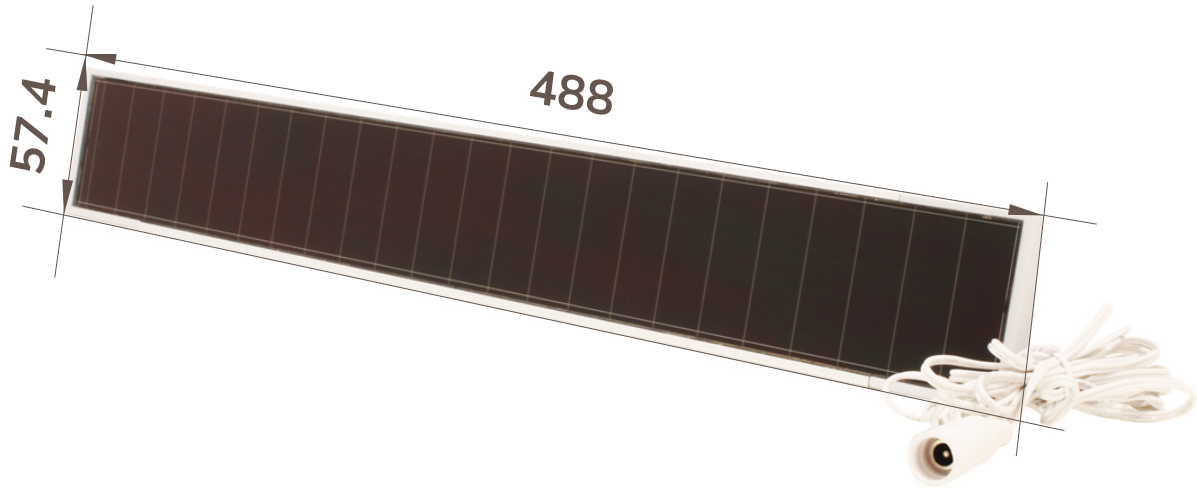

Max Power	Max Working Voltage	Open Circuit Voltage	Open Circuit Current	Max Working Current	Unit Size	Test Conditions
1.55W(±5%)	11v	15.3v	0.18A	0.14A	488x57.5x15mm	AM1.5 1000W/m 25°C

### Benefits

- Very discreet
- Suitable for indoor use
- Simple plug in connector
- Eco-friendly
- 2.4m power lead
- Provides full charge in 2 days



# DotcomBlinds | Blackout Cassette System

*Mains & Battery Motor*

## Important Note :

Due to the nature of the light omitting seal created by this blackout blind, windows must be closed while this blind is down. Opening a window behind the blind could cause a vacuum resulting in the fabric being sucked from the side channels and resulting in damage to the blind.

Any damage caused by operating our Cassette Blinds with a window open or in an environment with a high air flow will void the warranty.

These blinds are designed to be used with windows fully closed.

We expect our cassette blinds to provide darkness in your room for standard use. However, we cannot guarantee absolute darkness due to differences in installation, location and light direction. Every care and attention has been made to engineer this type of blind to give maximum levels of darkness.